

16 SERIES MODIFICATIONS FOR CAM UNIT

DISCHARGE COLLAR

- 1: REMOVE THE EXISTING FRONT SCREW FROM THE LEFT SIDE OF THE CONDENSOR COVER.
- 2: PLACE THE DISCHARGE COLLAR ONTO THE 16 CABINET INSURING THE HEM LOCKS IN UNDER THE TOP FLANGE OF THE FRONT COVER.
- 3: ALIGN THE HOLE IN THE BACK LEFT CORNER OF THE COLLAR WITH THE EXISTING HOLE IN THE CONDENSOR COVER AND REPLACE THE SCREW THAT WAS REMOVED.
- 4: ENSURE THAT THE COLLAR IS PUSHED BACK AND THE HEM IS FULLY ENGAGED TO THE FLANGE ON THE FRONT COVER OF THE UNIT. USE SUPPLIED SELF TAPPING SCREW TO ATTACH THE RIGHT SIDE OF THE COLLAR. ONLY USE THE HOLE SUPPLIED IN THE COLLAR AS IT HAS BEEN ALIGNED SO IT DOES NOT AFFECT ANY OTHER PART OF THE UNIT.

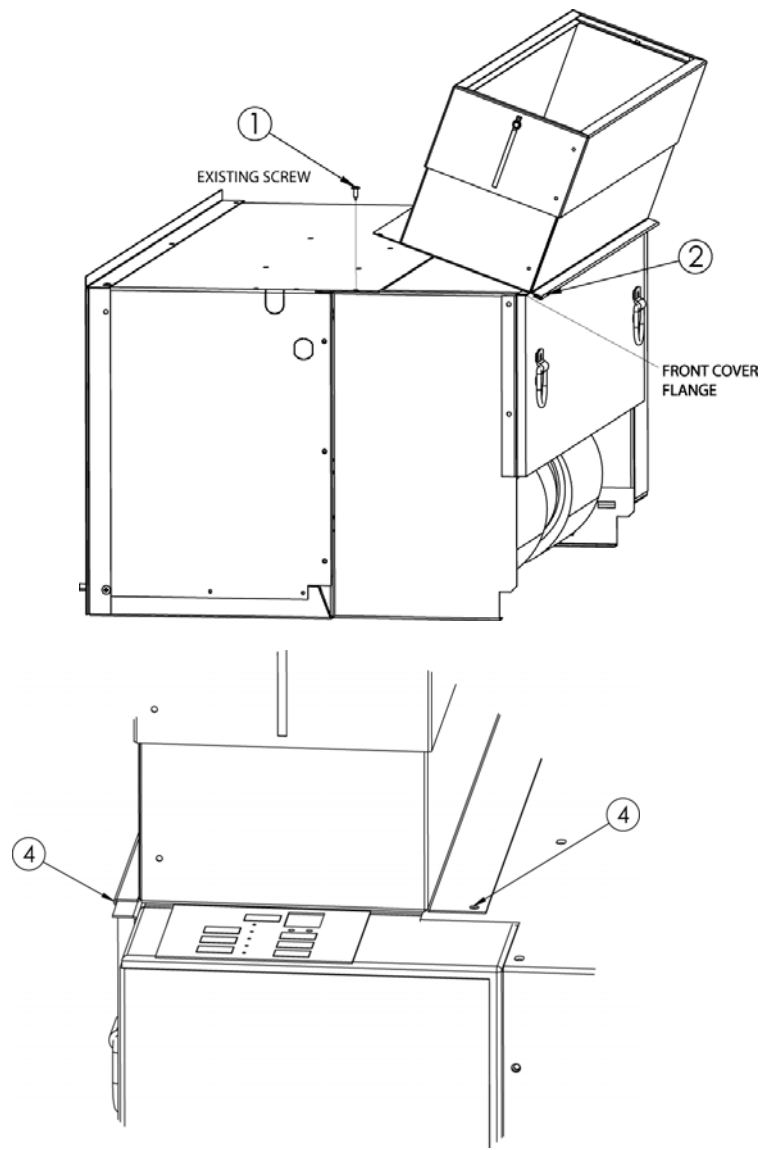

ANGLE INSTALATION

1: REMOVE EXISTING SCREW FROM THE BACK TOP CORNER OF THE CONDENSOR COVER. ALIGN TOP ANGLE FLANGE HOLE WITH EXISTING HOLE AND USING THE SCREW THAT WAS REMOVED ATTACH THE TOP FLANGE.

2: ALIGN THE TOP ANGLE SO THAT IT IS PARALLEL TO THE CONDENSOR COVER. ATTACH THE OTHER END USING THE EXISTING HOLE AND THE SUPPLIED SELF TAPPING SCREW. SECURE THE TOP ANGLE FULLY BY INSERTING A THIRD SELF TAPPING SCREW THREW THE CENTER HOLE OF THE TOP ANGLE.

3: REMOVE THE EXISTING SCREW FROM THE BOTTOM BACK OF THE CONDENSOR COVER AND ATTACH THE SIDE BRACKET USING THE EXISTING HOLE. ALIGN THE SIDE BRACKET PARRALLEL TO THE CONDENSOR COVER AND SECURE USING THE TOP HOLE AND THE SUPPLIED SELF TAPPING SCREW. REPEAT THIS PROCEEDURE FOR THE OTHER SIDE.

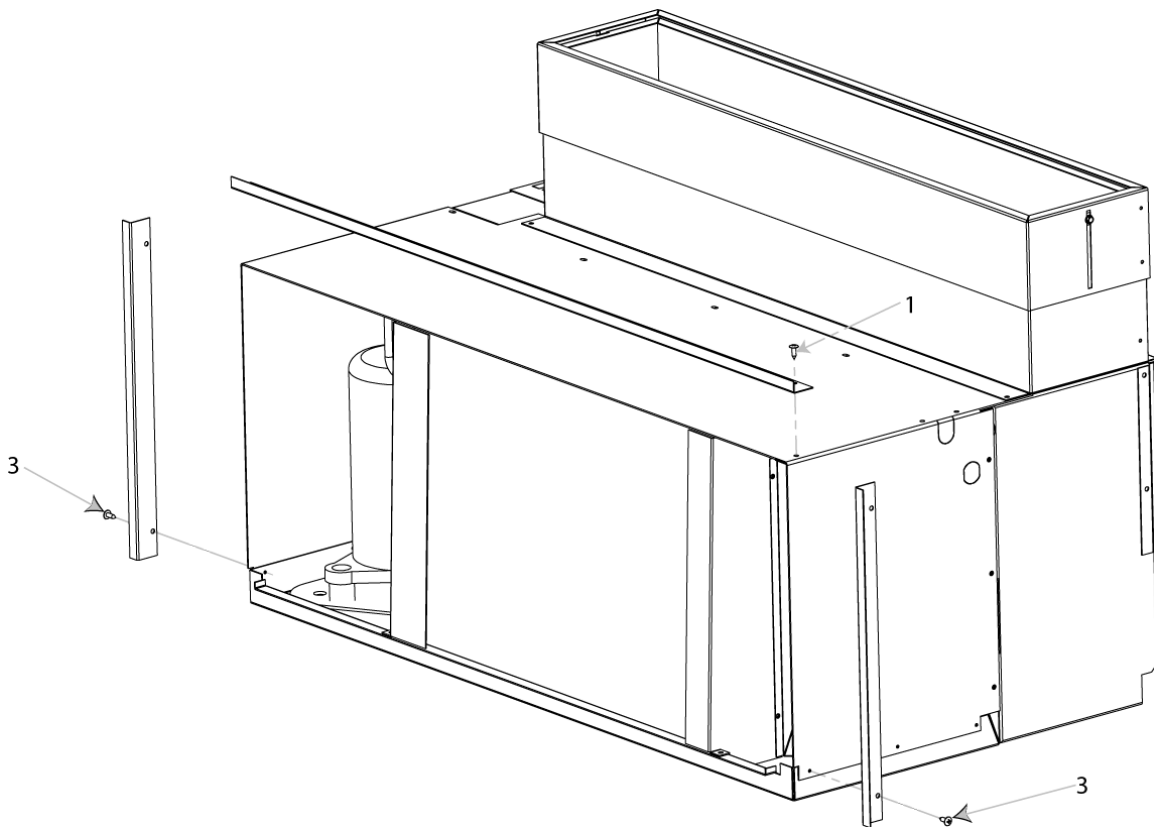

SEAL STRIP

APPLY $\frac{1}{2}$ " X $\frac{1}{2}$ " SEAL STRIP TO THE BACK FLANGES TO ALLOW FOR A PROPER SEAL TO THE BACK OF THE WALL SLEEVE.

UNIT INSTALLATION

AFTER ASSEMBLING THE CAM MODIFICATION ANGLES AND DUCT THE UNIT CAN BE INSTALLED. SLIDE THE UNIT INTO THE SLEEVE ENSURING IT IS PROPERLY SEATED. AFTER THE UNIT IS INSTALLED ADJUST THE DISCHARGE COLLAR SO THAT IT SEALS TO THE DISCHARGE GRILLE AND SECURE BY TIGHTENING THE TWO SIDE SCREWS.